

SMILE PUNCH

TR-PL



How to operate TR-PL

1. Usage

Punching work for making snap buttons, or eyelet work of jumper, jacket, jean, coat, knitwear, leatherware, bag, belt etc.

2. Special feature

- It is possible to reduce the manufacturing process and manpower because the direct punching work could save the task of position marking.
- It prevents loss by accurate punching because TR-P.1 starts punching work just after pressing and possible to work, holding material with one hand.
- TR-P.1 makes hole neatly due to no dancing of texture.
- TR-P.1 prevents shock, noise and possible hand injuries due to hammering.
- Even a beginner can work more efficiently like a skilled workman.
- Due to portable merit of TR-PL, punching work is possible anywhere.
- It is possible to change blades according to sizes of hole to be punched.

3. How to use

- Turn on the power switch and lay a suitable working pad on the ground.
- With holding material with a hand, press to work the punch vertically and strongly.

4. Maintenance

- In case of dull blade : Grind the blade with a sand paper(#600~#800) or a grinder. (It must be ground vertically to be sharp.)



- Exchang of blade : Please refer to below images,



1 Prepare tools, referring to left image 1,



2 Put the tools like this, referring to image 2.



3 Fix left handle by hand and then turn wrench plate by counter clock wise to release the punch blade.



4 After releasing bolt, now you can replace punch blade with as you want. Please watch out the direction of "CORK".



5. Specifications

Model	Power Supply	Work scope	Motor Speed	Machine Size (Net Weight)	Packing Size (Gross Weight)
TR-PL (Smile Punch)	AC110/220V, 50/60Hz	Φ2~12mm	1,700 rpm	230×150×150MM (7.3kgs)	280×370×260MM (10.1kg)

- Exchange of cork : Separate it with "L" wrench of 3mm size.
- Exchange of inner wire : If the inner wire is loosed or cut, unscrew the hexagonal bolt at the end of handle with a spanner of 14mm size and then pull out the inner wire strongly, biting with a vise.
If the inner wire is not taken out, wire set should be changed newly.
If you often feel strange sound at handle, grease on the cork.

6. A/S Reference :



泰友精密
TAEWOO CO., LTD.

ADDRESS : A-302, 1025-1 DOGOK-RI, WABU-EUP,
NAMYANGJOO, KYONGGI-DO, KOREA
TEL +82 31 521-6904~7
FAX +82 31 521-6908
E-mail : cutex@chol.com
www.cutex.kr

스마일 펀치 부품도 PART LIST OF SMILE PUNCH(TR-PL)

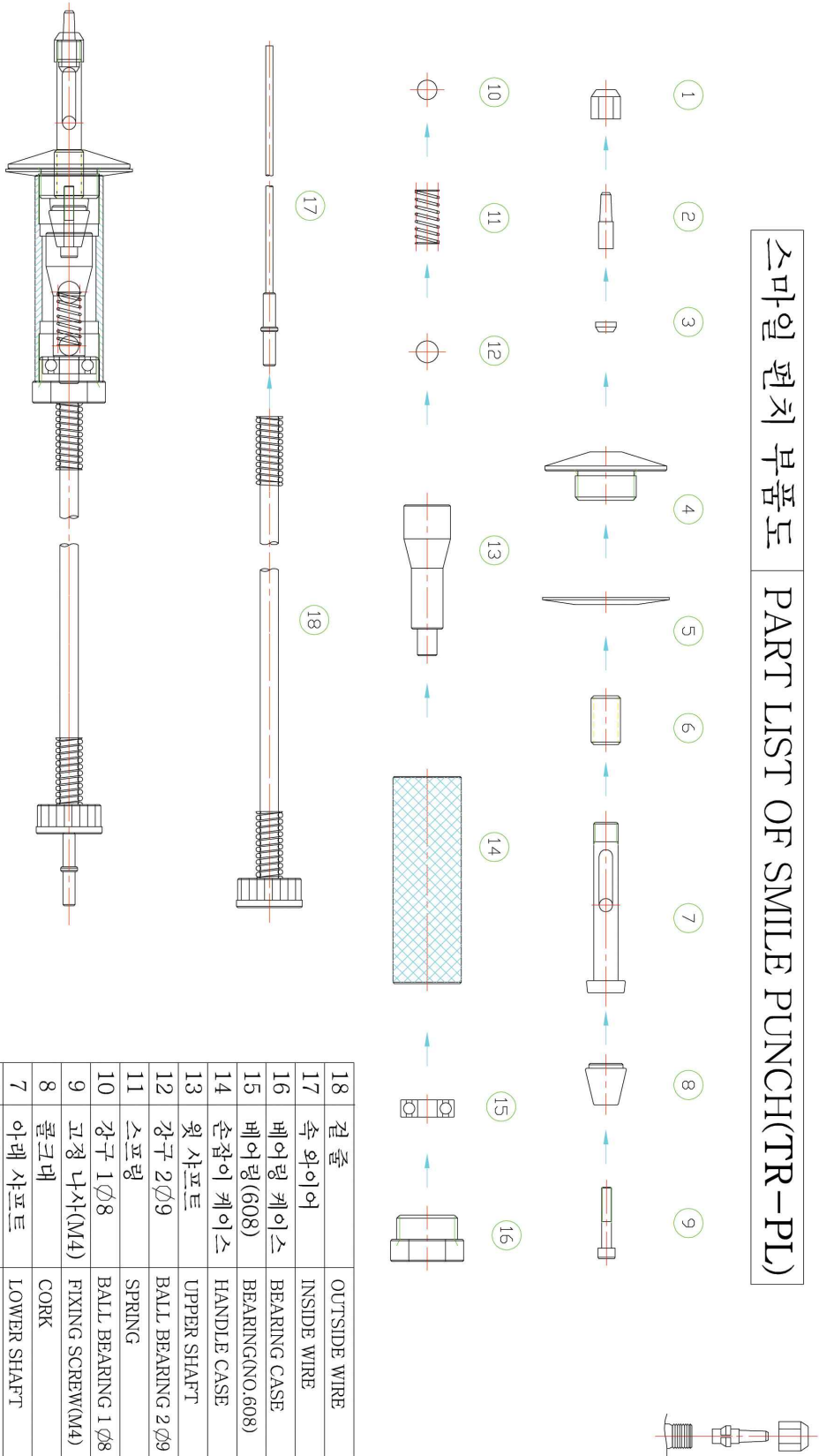

18	겉 줄	OUTSIDE WIRE	1
17	속 와이어	INSIDE WIRE	1
16	베어링 케이스	BEARING CASE	1
15	베어링(608)	BEARING(608)	1
14	손잡이 케이스	HANDLE CASE	1
13	윗 샤프트	UPPER SHAFT	1
12	강구 2 ϕ 9	BALL BEARING 2 ϕ 9	1
11	스프링	SPRING	1
10	강구 1 ϕ 8	BALL BEARING 1 ϕ 8	1
9	고정 나사(M4)	FIXING SCREW(M4)	1
8	클크대	CORK	1
7	아래 샤프트	LOWER SHAFT	1
6	오일레스	OILLESS	1
5	고무 받침대	RUBBER PAD	1
4	손잡이 받침대	HANDLE PAD	1
3	날 조임링	BLADE FIX-RING	1
2	날 조임너트	BLADE FIX-NUT	1
1	날	BLADE	1
NO	부품명	PART NAME	QTY